

# **CDM6240**

# **Technical Manual**

**Version: V1.2**

**Release: 2009-6-24**

# Contents

<b>1. General Description</b> .....	<b>1</b>
<b>2. Model</b> .....	<b>1</b>
<b>3. Terms</b> .....	<b>1</b>
<b>4. Overview</b> .....	<b>1</b>
<i>4.1 Presentation</i> .....	<i>1</i>
<i>4.2 Dimensions (mm)</i> .....	<i>3</i>
<b>5. Functionalities</b> .....	<b>4</b>
<b>6. Features</b> .....	<b>5</b>
<b>7. Technical Specifications</b> .....	<b>5</b>
<i>7.1 Electrical specifications</i> .....	<i>5</i>
<i>7.2 Performance specifications</i> .....	<i>6</i>

## **1. General Description**

CDM6240 dispenser is an advanced cash dispensing module, experiencing years of research and development by GRGBanking, has possessed completely independent intellectual property and reached international advanced level. It consists of cassette and frame, reject tray, note feeder, high-precise detection unit and transport unit.

The reject tray with lock may be selected and the cassette may be expanded up to six.

The dispenser precisely picks up required notes from the assigned cassette to the user, and returns unqualified notes to the reject tray, with high-reliability, easy to operate and maintain.

## **2. Model**

CDM6240 / CDM6240R

## **3. Terms**

CDM----Cash Dispense Module

## **4. Overview**

### **4.1 Presentation**

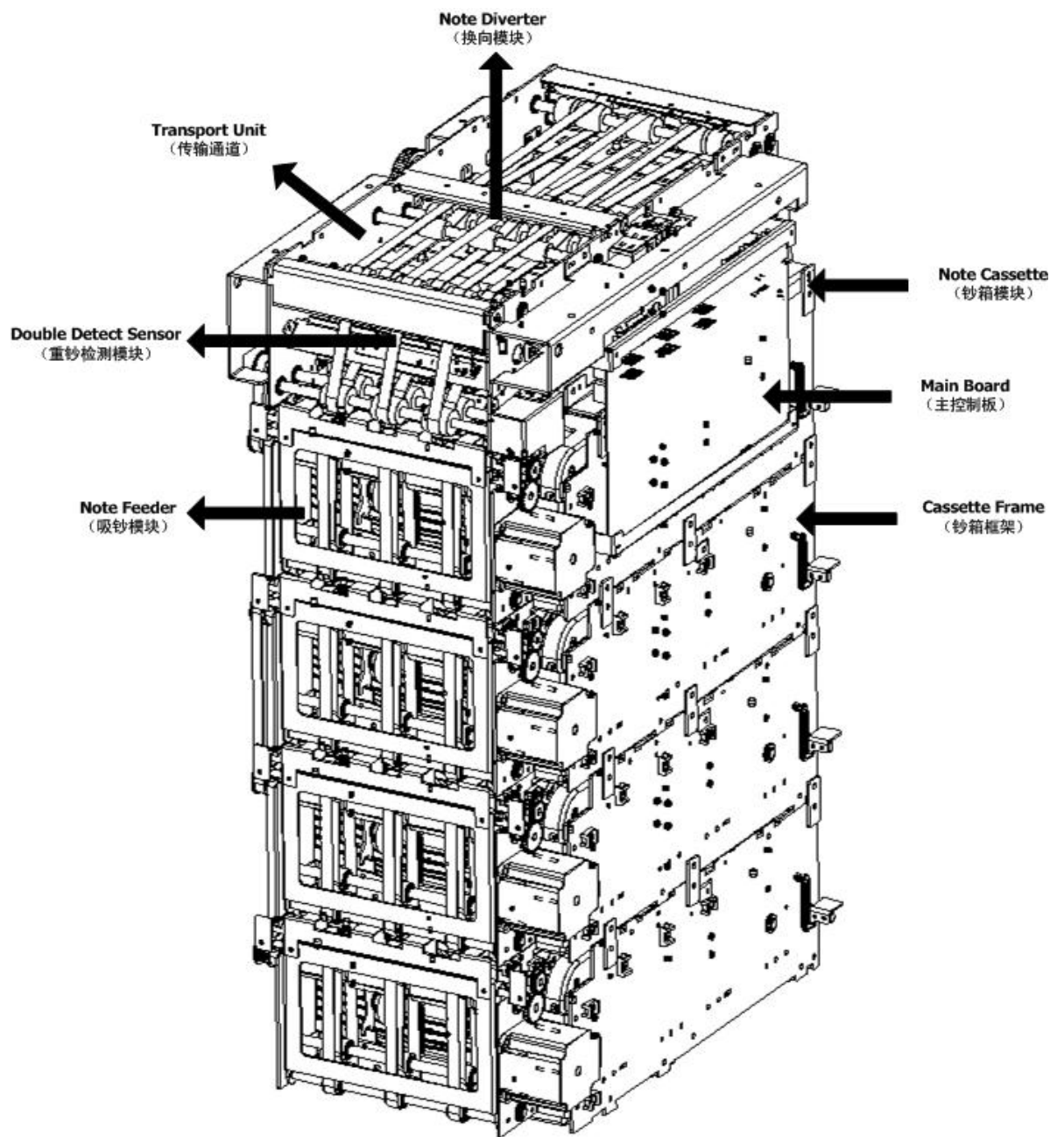

## 4.2 Dimensions (mm)

CDM6240R:

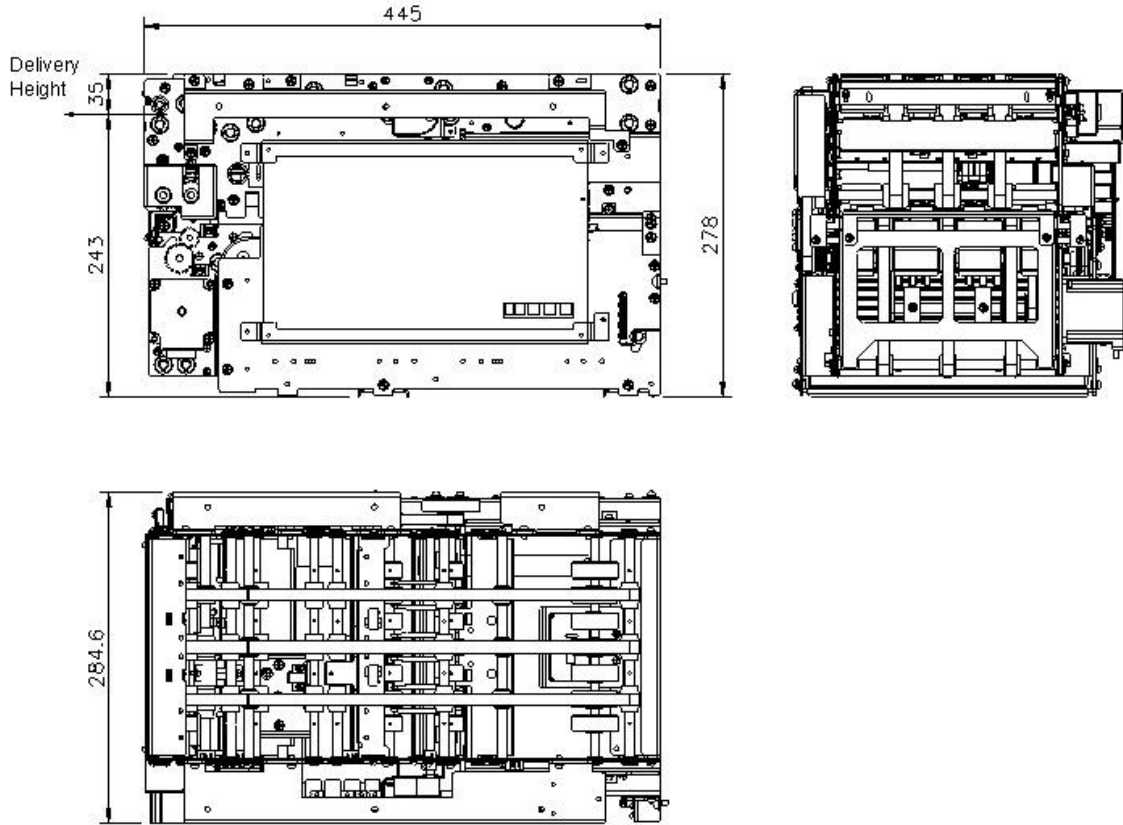

Above is the single cassette height, with the increase of every cassette, the height shall be added by 142.5mm.

CDM6240:

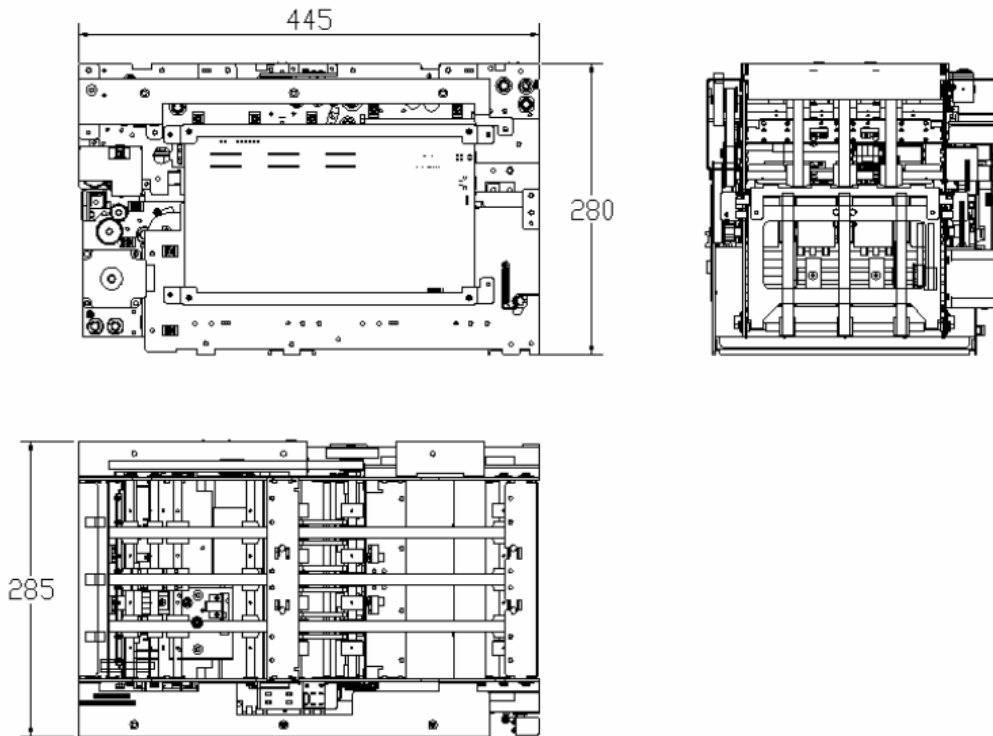

Above is the single cassette height, with the increase of every cassette, the height shall be added by 142.5mm.

## 5. Functionalities

- ◆ Friction dispensing, strongly adapts to all kinds of paper money.
- ◆ Up to six cassettes, each contains 2200 notes.
- ◆ 7 notes/second high dispensing speed.
- ◆ Maximum 100 notes per transaction.
- ◆ Reliable and steady detect unit (double, folded and worn notes etc detected).
- ◆ Low level detection.
- ◆ Self Calibration function, automatically records the note information.

## 6. Features

- ◆ Optional high-security cassette and reject tray with lock and seal-leading.
- ◆ Log record and inquiry function, transaction log recorded for at least three months.
- ◆ Offline self-diagnostic function, convenient to debug.
- ◆ Onsite replacement of wearing part, easy to maintain.
- ◆ Modular design, easy to disassemble and assemble.

## 7. Technical Specifications

### 7.1 Electrical specifications

Item		Description
Power	Input voltage	AC 110V ± 10%; 220V ± 10%
	Output voltage	DC 24V, 200W
	Consumption	Idle 10W; Operating 50W
Environmental conditions	Operating temperature	0°C~50°C
	Operating humidity	20%~90%RH (non-condensing)
	Temperature change rate	10°C per hour
	Humidity change rate	10% per hour
Communication interface		RS-232/ USB (optional)
Weight	<b>CDM6240:</b> 16.9 Kg (single cassette weight, with the increase of every cassette, the weight shall be added by 9.9kg.)	
	<b>CDM6240R:</b> 18.9 Kg (single cassette weight, with the increase of every cassette, the weight shall be added by 9.9kg.)	

## 7.2 Performance specifications

Item		Description
Note cassette	Expandability	Up to 6
	Cassette capacity	2200 notes
	Reject tray capacity	Single reject, at least 100 notes
	Security	Mechanical lock and lead sealing
Media ranges	Length	110mm ~172 mm
	Width	55mm ~85 mm
	Thickness	0.06mm ~0.18 mm
Dispensing system		Friction
Dispensing mode		Single
Dispensing speed		7 notes/second
Maximum notes per transaction		100 notes
Low level detection		50~250 notes (adjustable)
Reject mode		Single
Maintenance		Front/Rear